

PROPOSED PART LAY OUT PLAN
FOR COMMERCIAL PLOTS
NEAR RAM MANOHAR LOHIA
HOSPITAL

AT VIBHOOTI KHAND
GOMTI NAGAR SCHEME
LUCKNOW

DETAIL OF PLOTS:-

S.NO	TYPE	SIZE	AREA(IN SQ.M.)	NOS
	PLOTS	4.0 M. X 10.00 M.	40.0 SQ.M.	48

AREA STATEMENT:-

S.NO	AREA	PARTICULARS	AREA IN SQ.M.	%AGE
	TOTAL	AREA OF LAND	4650.71	100.00
	AREA	UNDER R/W	493.80	10.62
	AREA	UNDER PLOTS	2206.00	47.43
	AREA	UNDER OPEN/PARKING	867.76	18.66
	AREA	UNDER RODS	1083.15	23.29

NOTES:-

1. THIS LAY OUT PLAN IS BASED ON THE SURVEY PLAN SENT BY EAPP ON FILE NO 92/C.T.P/CAMP.
2. THE LAND IS ACQUIRED AS INFORMED BY SE(LA) VIDE LETTER NO 466/SIN/A.C./369/ 2001 DATED 26.4.01
3. THE LAND IS UNALLOTTED AS PER THE REPORT OF CFA MDATED 6.8.01 ON FILE NO 92/C.T.P/CAMP
4. FOR ANY CONSTRUCTION ON THE PROPOSED PLAN CONTROL DRAWING OF LDA SHALL BE FOLLOWED.

TENTATIVE:-

R E V I S I O N

LUCKNOW DEVELOPMENT AUTHORITY

DATE:-20 JUN 2001	 NORT SCALE: 1:1250
DRG. NO. POLP/COMRN.LH/VIB./G.N/01	
DEALT BY:-JASVINDER	
CHECKED BY:-	

PLANNING COMMITTEE APPROVAL COMMITTEE

RAVI JAIN
A.T.P.

BHART BHUSHAN
C.T.P.

V.K.GUPTA
C.T.C.P.

BHARATI SHUSHAN
C.T.P.

DIWAKAR TRIPATHI
V.C.

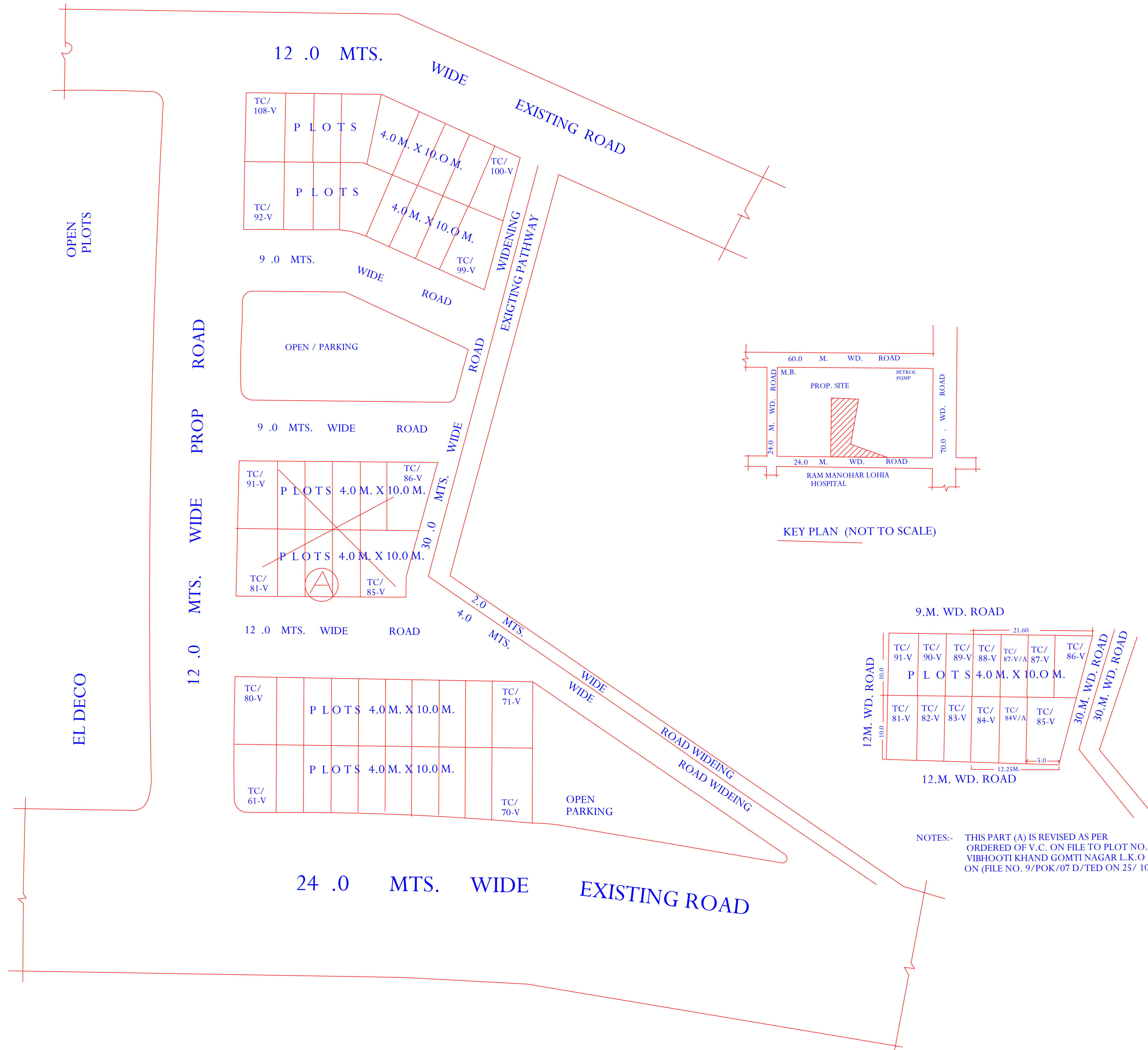

NOTES:- THIS PART (A) IS REVISED AS PER ORDERED OF V.C. ON FILE TO PLOT NO.TCV.-85 VIBHOOTI KHAND GOMTI NAGAR L.K.O ON (FILE NO. 9/POK/07 D/TED ON 25/ 10 / 7)